

Black Steel Slip On Flange Table E

SIZE (mm)	CODE	WORKING PRESSURE kPa (Atmospheric)	Max Hydrostatic Test Pressure, kPa*	MATERIAL
15	STE015	1,400	2,100	Carbon Steel
20	STE020	1,400	2,100	Carbon Steel
25	STE025	1,400	2,100	Carbon Steel
32	STE032	1,400	2,100	Carbon Steel
40	STE040	1,400	2,100	Carbon Steel
50	STE050	1,400	2,100	Carbon Steel
65	STE065	1,400	2,100	Carbon Steel
80	STE080	1,400	2,100	Carbon Steel
100	STE100	1,400	2,100	Carbon Steel
125	STE125	1,400	2,100	Carbon Steel
150	165.1 STE150/165.1	1,400	2,100	Carbon Steel
	168.3 STE150/168.1	1,400	2,100	Carbon Steel
200	STE200	1,400	2,100	Carbon Steel

*In accordance with AS2129

Flange Dimensions

SIZE (mm)	Number of Holes	Flange Diameter	Pitch Circle Diameter (mm)	Bolt Hole Diameter (mm)	Flange Thickness (mm)	Bore Hole (mm)
		(mm)	B	C	D	E
15	4	95	67	14	6	22
20	4	100	73	14	6	27
25	4	115	83	14	7	34
32	4	120	86	14	13	42.6
40	4	135	98	14	12	48.7
50	4	150	114	18	12	60.7
65	4	165	127	18	12	73.4
80	4	185	146	18	12	89.3
100	8	215	178	18	13	114.7
125	8	255	210	18	14	141.7
150	165.1	8	280	235	17	165.1
	168.3	8	280	235	17	168.7
200	8	335	292	22	19	219.5

- CTS Copper Capillary Socket Fittings manufactured in accordance with AS 3688
- Adapters meet requirements of a maximum operating pressure of 1.4MPa where working temperature
- Electrolysis Insulator made from EDPM rubber to prevent contact from Steel Backing Flange and Copper

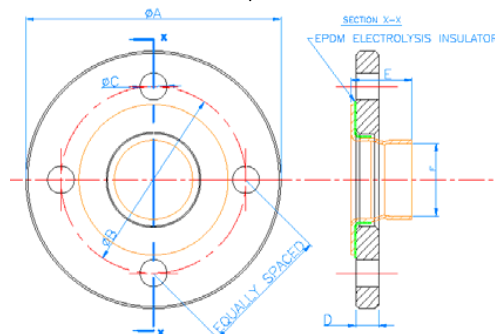

For Commercial, Institutional or Industrial Applications